

CERTIFIED RECORD OF LAND CORNER MONUMENTATION

History of original corner establishment:
None

*

DIAGRAM
T10S R31E
W1/16
C-----C
S30

Description of corner evidence found:

Description of monument and accessories I establish to perpetuate the original location of this corner:

Set a 2x28" aluminum monument 22" in the ground.
I establish new bearing trees:
A 7" L.Pine bears S 53^o W, 36.2 ft, scribed CW1/16S30BT.
A 9" Larch bears N 19^o E, 27.2 ft, scribed CW1/16S30BT.

T10S R31E
W1/16
C-----C
S30
PLS1918
1988

Sun Cadastral Survey, Cont. No. 53-04H1-7-4011
Field Book: 7-5
Work accomplished: 10/24/88
Witnesses: Tyler Parsons, Louise Parsons, Lowell Seaders

New BTs have 3/4" brass washers marked PLS1918 attached to the BT blaze, faces and bands painted with red tree marking paint, and BT tags and Land Survey Monument signs. A steel fence post with Land Survey Monument sign is driven approximately 3-5 feet from the corner.

PARSONS SURVEYING
1915 S.E. Stone Street
Corvallis, OR 97333
(503) 752-7515

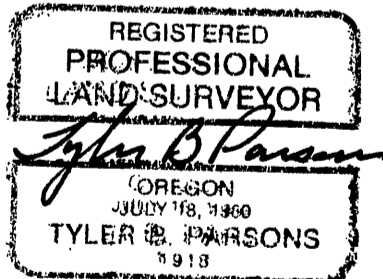

Office of County Surveyor County of GRANT
State of OREGON, I hereby certify that the within instrument was filed in this office
for record on the 7th day of Feb, 1989

Robert D. Leggett by _____
(COUNTY OFFICIAL) (DEPUTY)